



E-3WAY SWITCH INSTRUCTIONS

OZRoll Pty Ltd
174 Cavan Road
DRY CREEK SA 5094
AUSTRALIA.

E sales@ozroll.com.au
W www.ozroll.com.au

The OZRoll Logo is a registered
trademark of OZRoll Pty Ltd.

Copyright © 2008. OZRoll Pty Ltd. All
Rights Reserved.

No part of this publication may be reproduced,
stored in a retrieval system, or transmitted, in
any form or by any means, electronic, mechanical,
photocopy, recording, or otherwise, without the
prior written permission of OZRoll Pty Ltd.

Due to continued research & development changes
may be made to the information in this publication
without obligation to notify any person of such
revision or changes.

INSTRUCTIONS E-3WAY SWITCH
Version 02 - FEB 2010.
PART NUMBER 15.920.346

SPECIFICATIONS.

E-3Way Switch

Size: H 83 mm
W 83 mm
D 25 mm

Weight: 80g



1. INTRODUCTION

The E-3Way Switch allows three automated
window roller shutters to be operated by only one
Controller. The E-3Way Switch uses the power
delivered from the Controller to drive one of three
shutters selected by the operator. This makes it
ideal for operating bay windows. **Only one shutter
at a time can be controlled.**

2. OPERATING INSTRUCTIONS

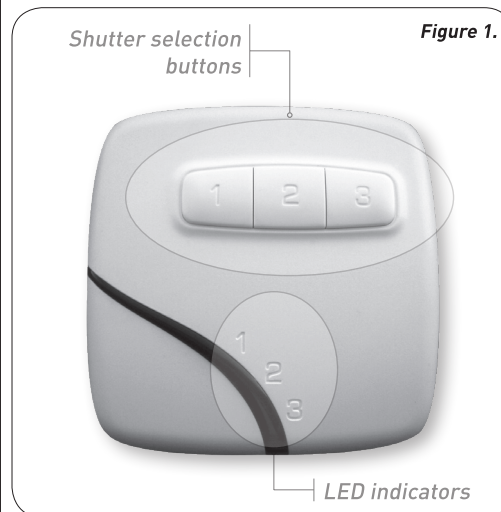

To operate a particular shutter, first select the
appropriate button on the E-3Way Switch, then
use the Controller to drive that shutter up or
down. Refer to Figure 1

Once a button is pressed the corresponding
LED will light to indicate the selection that has
been made. This selection will remain valid for
60 seconds before reverting to the programmed
default shutter. The E-3Way Switch will also
revert back to the default shutter after each
operation is completed (and the LED goes off).

If no selection is made the default shutter
will be the one that is controlled. Any of the
shutters connected to the E-3Way Switch can be
programmed to become the default shutter.

To program, press and hold the button on the
E-3Way Switch that corresponds to the desired
default shutter. This button must be held in for
five seconds. The LED for the selected default will
flash to indicate that it has been programmed.

Only one shutter at a time can be operated.
To operate all three shutters it is necessary to
wait for the operation on the first shutter to be
completed before repeating it for the others.

3. BATTERY REPLACEMENT

If no LEDs light when the buttons are pressed
(or they are very dim) then the battery may need
replacing. To change the battery:

1. Purchase a new CR2430 battery (available from
specialised battery stores or most chemists).
2. Remove the decorative cover as discussed in
the Installation section below.
3. Slide the old battery out of its holder.
4. Slide in the new one. Ensure that the
orientation of the new battery is the same as the
original, ie positive (+) facing out.
**(NOTE: Ensure no fingerprints are left on the
replacement battery. It is best to handle it with
a clean tissue.)**
5. Test the operation of the E-3Way Switch by
pressing the buttons.
6. Replace the decorative cover by first positioning
the top clips and then latching at the bottom.

4. INSTALLATION

Expose the mounting holes by removing the
decorative cover. Insert the blade of a small flat
bladed screwdriver into one of the notches on the
bottom of the E-3Way Switch, and lever the cover
off. Refer to Figure 2.

Remove the YELLOW tag under the battery. The
E-3Way Switch will not operate until this tag has
been pulled out.



The holes for the mounting screws will now be visible.
Determine a suitable mounting position for the
Controller and the E-3Way Switch. Bear in mind
that the Controller and E-3Way Switch must be
connected by a cable that is **600mm long**.
Follow the installation instructions for the Controller.
The mounting method for the E-3Way Switch will
depend on the construction of the wall.
(Refer to the details on page2.)

4. INSTALLATION CONT'D

Plasterboard Walls

Plasterboard walls will require the use of a C-Clip Bracket (available in E-Flush Mount Kit 15.592.000).

To install the E-3Way Switch use the template to mark the centres of the large central hole and two small fixing holes.

The bracket is suited to fitment in a 50 to 55 mm central hole.

The diameter of the fixing holes should be 10mm. Fit the C-Clip Bracket and use the tab to hold it in position, as shown.

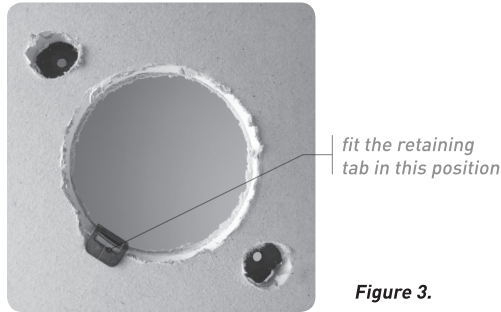

Figure 3.

Solid Walls

Use the template to mark the centres of the holes. It is recommended that a 40mm hole be made in the centre to make it easier to feed the wiring looms through.

Drill appropriately sized holes and use two wall plugs to mount the Wall Plate.

5. WIRING THE E-3WAY SWITCH

If the back of the E-3Way Switch is viewed the connection terminals can be seen. Refer to Figure 5.

There are three sets of **HORIZONTAL** terminals for the connection of each of the window shutter drives. These sets of terminals are marked W1, W2 and W3 (for Window 1 etc). Each of these sets has terminals marked A and B.

There is also one set of **VERTICAL** terminals for the connection of the Controller. These terminals are marked **FROM CONTROLLER** ① and ②.

3.1 Window Shutter Drive Connection

Connect the loom from the first window shutter drive to the W1 terminal set. The connection order will depend on which side of the shutter the drive is installed.

5. WIRING CONT'D

Left Hand Installation.

A **left-hand** installation is defined as having the drive on the left-hand side of the shutter when viewed from inside the house. For these installations connect the **RED** wire from the drive to the terminal marked "**A**". Connect the **BLACK** wire from the drive to the terminal marked "**B**". Refer to Figure 5.

Right Hand Installation.

A **right hand** installation is defined as having the drive on the right hand side of the shutter when viewed from inside the house. For these installations connect the **RED** wire from the drive to the terminal marked "**B**". Connect the **BLACK** wire from the drive to the terminal marked "**A**". Refer to Figure 5.

Repeat the above process for the other two shutter drives using the W2 and W3 terminal sets.

3.2 Controller Connection

The E-3Way Loom (part number 15.920.326) is required to connect the Controller to the E-3Way Switch.

3.2.1 Connect this loom to the "FROM CONTROLLER" terminals on the E-3Way Switch. The **RED** wire connects to the terminal marked ①. Connect the **BLACK** wire from this loom to the terminal marked ②.

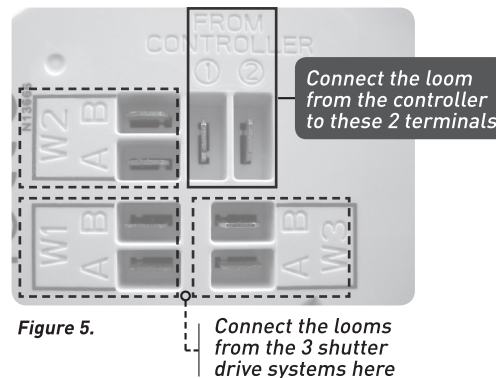

Figure 5.

3.2.2 Install and wire up the Wallplate or In Wall Battery as per their individual installation instructions. The only difference from a normal installation will be that the wiring from the roller shutter drive motor will not be connected. Instead the E-3Way Loom will be connected.

Connect the **RED** wire from this loom to the terminal marked ①. Connect the **BLACK** wire from this loom to the terminal marked ②.

3.2.3 Test the operation of the E-3Way switch.

3.2.4 Once satisfied replace the decorative cover.

6. TROUBLESHOOTING

SYMPTOM	REMEDY
The Controller will not operate any shutters.	<ul style="list-style-type: none">Ensure the spade terminals for each shutter have been firmly pushed onto the E-3Way Switch terminals.
A shutter operates in the reverse direction to the buttons.	<ul style="list-style-type: none">Swap the wires (spade terminals) for that shutter around on the back of the E-3Way Switch.
The Controller will not operate a particular shutter.	<ul style="list-style-type: none">Ensure the spade terminals for that shutter have been firmly pushed onto the E-3Way Switch terminals.
The Controller operates the wrong shutter	<ul style="list-style-type: none">Press the button on the E-3Way Switch corresponding to the desired shutter.
The E-3Way selector switch operates the wrong shutter	<ul style="list-style-type: none">Move the wires for the shutter to the correct corresponding window terminals on the back of the E-3Way Switch.
LEDs are dim	<ul style="list-style-type: none">Replace the battery in the E-3Way Switch.
Only the default shutter operates	<ul style="list-style-type: none">Replace the battery in the E-3Way Switch.

7. PRODUCT WARRANTY & CUSTOMER SERVICE

Customer Care.

There are no user-serviceable parts in the E-3Way Switch. Opening any components will void your warranty. Do not dispose of in fire.

Contact your retail agent should service be required.

Product Warranty - OZRoll guarantees the E-Series components for 12 months from date of purchase against any defect in materials or workmanship under conditions of normal use and service, and subject to proof of the date of purchase being provided.

Warranty Service Conditions - OZRoll expressly limits its liability with respect to its products to the person who purchases the product from a OZRoll authorised reseller. OZRoll expressly limits its liability with respect to its products to: [in the absolute discretion of OZRoll]

1. The cost of having the goods repaired
2. The cost of replacing the goods: or
3. The cost of obtaining equivalent goods.

In the event of the goods requiring service under warranty, the owner is responsible for the prepaid cost of appropriate transportation to the authorized service organization. Whilst in transit the goods are at the owner's risk.

Should the goods be found to be in sound working order by the authorized service organization the owner may be charged a service fee.

The goods will not be eligible for service under this warranty if:

1. Proof of date of purchase cannot be provided.
2. The goods are not branded E-Series by OZRoll Pty Ltd.
3. The goods have been supplied to or used by a person other than the purchaser.
4. The defect was caused by an accident, misuse, abuse, improper installation or operation, lack of reasonable care and maintenance, unauthorized modification, loss of parts, tampering or attempted repair by a person not authorized by OZRoll.

OZRoll shall not be liable for any loss or damage arising from the purchase, use or inability to use this product or for any special, indirect, incidental or consequential damages. No other warranties, express or implied, are made. Nothing in this warranty excludes, restricts or modifies any condition, warranty, right or liability implied or protected by law where to do so would render this warranty, or any part of it void.